

All interior construction (hot boxes, baffles, roof sarking, roof timbers) shall be constructed from oriented strand 'sterling' board on timber frames. Surfaces facing human and bat access points to be painted matt black.

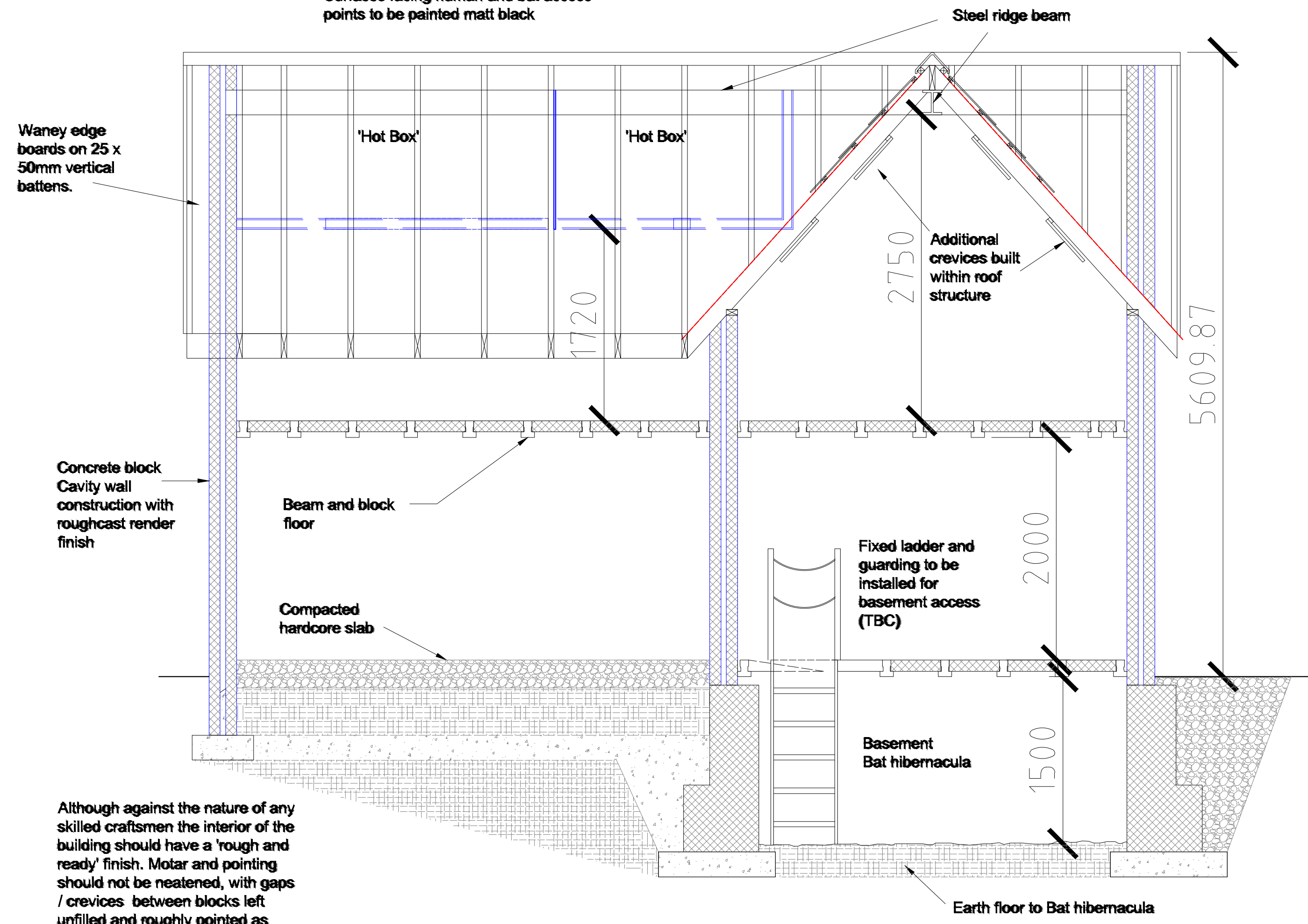

SECTION A-A

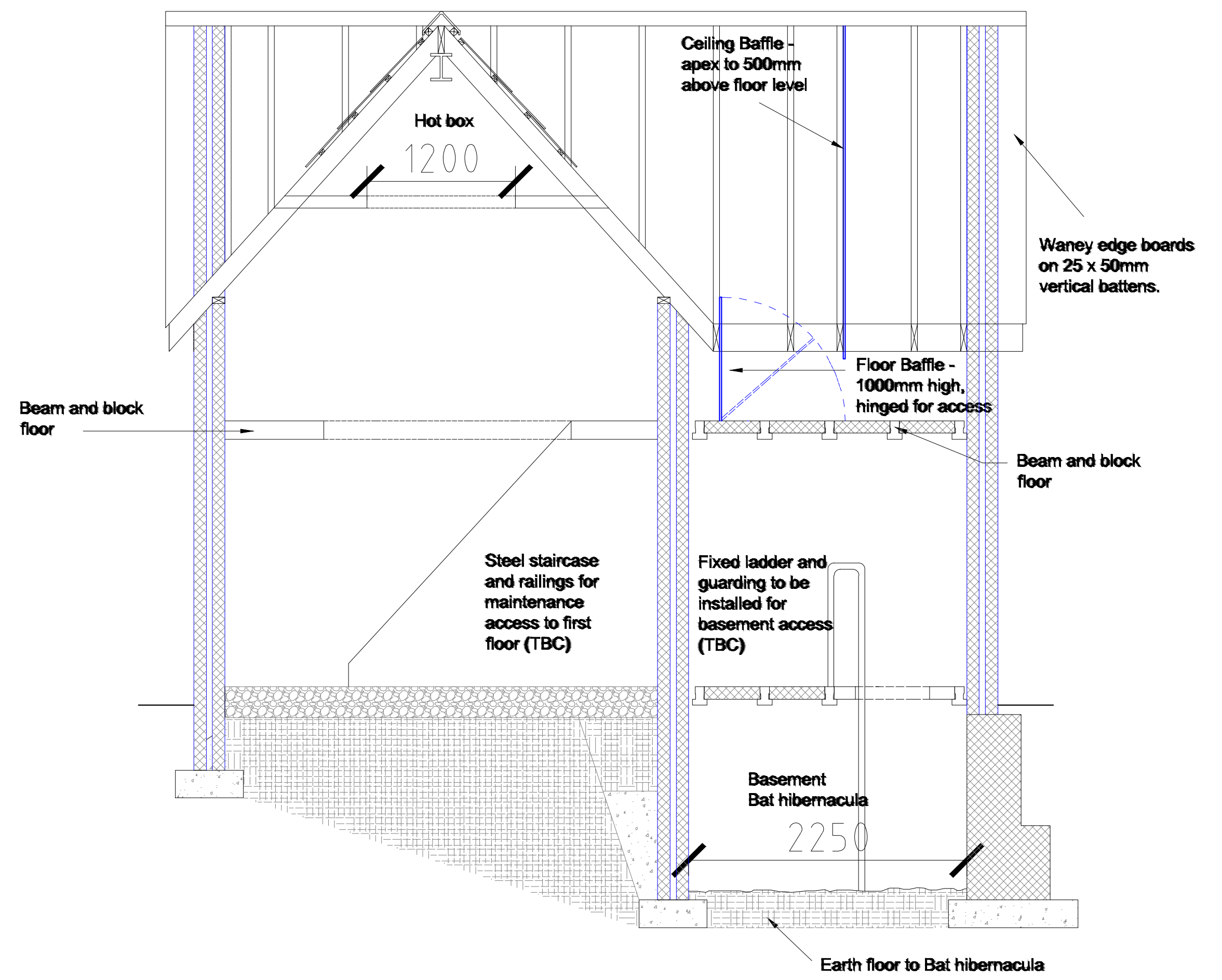

SECTION B-B

© Richard Crompton 2014

	Client:	Job:			Drawing Title:	
		Egnedol Wales Ltd			Maternity Roost Mitigation - Bat House Sections	
Date:	SCALE:	Drawn:	Check'd:	DRNG. NO.	REV.	
MARCH 2018	1:2500@A3	AD	LB	EGW-01-068	A	